



## VENUE SHEET

DATED: 2019-09-20

### VENUE TYPES

KLUBBEN: Club venue with standing audience (optionally seated)

OLJUDET: Conference venue with options to have smaller concerts

GJUTERIET: Art exhibition hall

CAFÉ D'AMOUR: Café located in the centre of the building connected to all venues, included in events booked for Klubben

### CAPACITY SOLD TICKETS

KLUBBEN: 400 standing // 120 seated

OLJUDET: 80 standing // 60 seated

Total capacity at 450 which includes **everyone** present in the building

### LOCATION/GPS

Södra Oskarsgatan 3A  
582 73, LINKÖPING  
SWEDEN

### DD

Latitude: 58.4178805

Longitude: 15.6252435

### DMS

N: 58° 25' 4.37"

E: 15° 37' 30.876"

### CONTACT

[skylten@linkoping.se](mailto:skylten@linkoping.se)

+(00)4673 077 14 16

Mon – thu: 08.00 – 20.00

Fri: 08.00 – 17.00

*Opening hours may vary during events*

# SKYLTEN

## PARKING

Skylden has 4 ordinary parking spaces on the north side of the venue and spaces for 1 nightliner (maximum 14 meters) on the east corner of the venue against the building walls.

Parking allowance is granted via a physical parking pass submitted by staff on arrival and has to be requested no later than 1 week in advance before arrival.

**Yellow:** Car parking

**Pink:** Nightliner Parking

**Green:** Basement Load-in

**Red:** Venue Load-in

Power to nightliner has to be requested no later than 1 week in advance before arrival and is available on the day of arrival between 13:00 – 00:45.

1 CEE 3 phase at 16A, 230V is available.

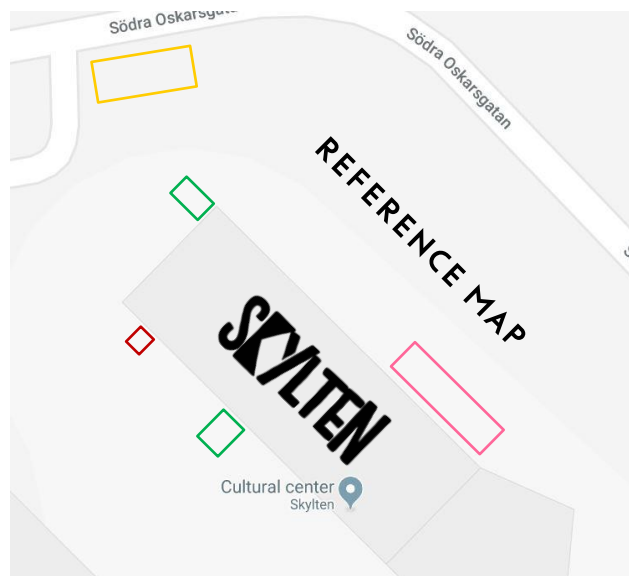

## LOAD-IN

Large and heavy objects load-in is done down the slopes and through basement, up the elevator to the venue floor. Maximum clearance (HxWxD) 200x117x205 cm which is based on the cargo elevator in the building. Smaller objects can with ease be carried up the steps right into the venue itself.

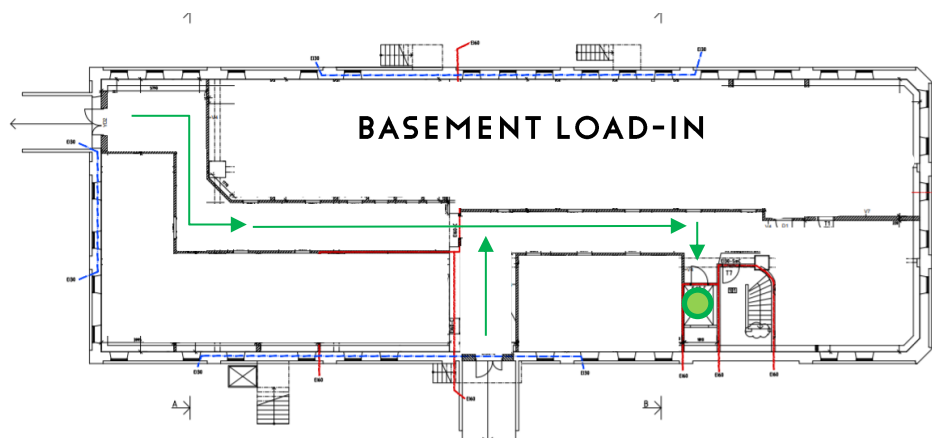



## ACCESSIBILITY

Every floor is connected with an elevator that opens and closes automatically. Majority of all the main doors have automatic door openers. If you have specific needs of accessibility you can always contact us in advance so that we can prepare for your arrival.

## SECURITY

During an emergency there are several functions in the building that makes sure that everybody can evacuate the building safely. There are in total 5 wide emergency exit out of the building that are brightly lit and visible at all times. If a fire should occur, the alarm system cuts the power to stage power outlets and lights up general lighting in the entire building. If a power outage should occur, emergency lighting will light up the stage and the entire building.

Public evacuation plans are available in the building. Please educate yourself on these after arrival. The evacuation plan can be sent digitally in advance if requested.

The following security specifications has to be met and maintained under the entirety of the event.

- Emergency exit doors must have a minimum of 120cm clear area in **all** angles, on both sides of the door. They must also under all circumstances remain closed
- The emergency exit signs above the doors and fire extinguishers has to be visible from all angles in the room they're located in.
- Emergency exit doors, must under all circumstances remain closed
- Emergency exit routes must be clear of heavy, unmoveable and flammable objects during all times.



## STANDARD RUNNING TIMES

If nothing else is negotiated, the following are the standard running times. Curfew times are non-negotiable.

### EVENTS TAKING PLACE MONDAY - THURSDAY

➤ <b>Get in</b>	<b>12.00</b>
➤ <b>Soundcheck</b>	<b>15.00</b>
➤ <b>Dörrar</b>	<b>18.00</b>
➤ <b>Show</b>	<b>19.00</b>
➤ <b>Show slut</b>	<b>21.00</b>
➤ <b>Loge curfew</b>	<b>22.00</b>
➤ <b>Curfew</b>	<b>22.30</b>

### EVENTS TAKING PLACE ON FRIDAYS AND SATURDAYS

➤ <b>Get in</b>	<b>14.00</b>
➤ <b>Soundcheck</b>	<b>16.00</b>
➤ <b>Dörrar</b>	<b>19.00</b>
➤ <b>Show</b>	<b>20.00</b>
➤ <b>Show slut</b>	<b>23.30</b>
➤ <b>Loge curfew</b>	<b>00.30</b>
➤ <b>Curfew</b>	<b>01.00</b>



## DRESSING ROOMS

Skylden has two available dressing rooms adjoining the stage in Klubben. On demand we are able to setup more dressing rooms in the basement if needed.

### DRESSING ROOM 1

A smaller dressing room with equipped with a half size fridge, catering table and furniture to accommodate maximum of **4 people**. The dressing room also has access to a toilet w/ shower. Access to stage is not available from inside the dressing room.

### DRESSING ROOM 2

A larger dressing room equipped with a half size fridge, catering table and furniture to accommodate a maximum of **6 people**. The dressing room has access to a toilet w/ shower and staircase access to **stage left**.

## TECHNICAL INFORMATION

Please read the separate technical documents specific to the venue you booked.